

MagPot 3 (NdFeB Pot systems with external thread pins)

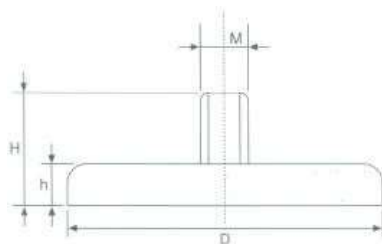

Part No. 型號	DØ (mm)	M (mm)	H (mm)	h (mm)	Adhesive Strength (kg) 吸附力	Weight (g) 自重
MagPot 3-10	10	3	12	5	2	4
MagPot 3-12	12	3	13	5	3	5
MagPot 3-16	16	4	13	5	6	8
MagPot 3-20	20	4	15	7	9	16
MagPot 3-25	25	5	17	8	22	30
MagPot 3-32	32	6	18	8	34	45
MagPot 3-36	36	6	18	8	41	57
MagPot 3-42	42	8	20	9	68	84
MagPot 3-48	48	8	24	12	81	130
MagPot 3-60	60	8	30	15	113	254
MagPot 3-75	75	10	34	15	164	550

Adhesive Strength

The given adhesive strength is determined by the vertical withdrawal of the magnet from a clean ground mild steel surface with thickness of 10 mm at room temperature.

Painted or un-ground surfaces may reduce the values.