

**MagPot 6 (NdFeB Pot systems with eye hook)**

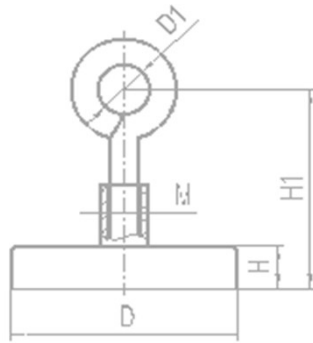

Part No. 型號	D Ø (mm)	M (mm)	H (mm)	H1 (mm)	D1 Ø (mm)	Adhesive Strength (kg) 吸附力	Weight (g) 自重
MagPot 6-16	16	4	5.2	30	7.5	6	12
MagPot 6-20	20	4	7.2	32	7.5	9	21
MagPot 6-25	25	5	7.7	32	8.5	22	33
MagPot 6-32	32	6	7.8	36	10.0	34	54
MagPot 6-36	36	6	7.6	36	10.0	41	64
MagPot 6-42	42	6	8.8	37	10.0	68	93
MagPot 6-48	48	8	10.8	45	11.0	81	150
MagPot 6-60	60	8	15.0	50	11.0	113	283

**Adhesive Strength**

The given adhesive strength is determined by the vertical withdrawal of the magnet from a clean ground mild steel surface with thickness of 10 mm at room temperature.  
Painted or un-ground surfaces may reduce the values.